



# ZIPPITY

*Easy Does It!*

## DAVIDSON HINGED PORTABLE FENCE KIT (65 ½" W X 38" H)

**30 MIN**

*Approximate assembly time*

Want to see a video on how to  
assemble this product?  
**Scan the QR code**

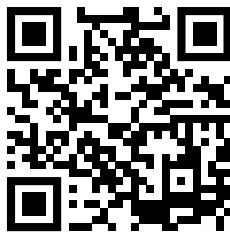

## ASSEMBLY INSTRUCTIONS ZP19062

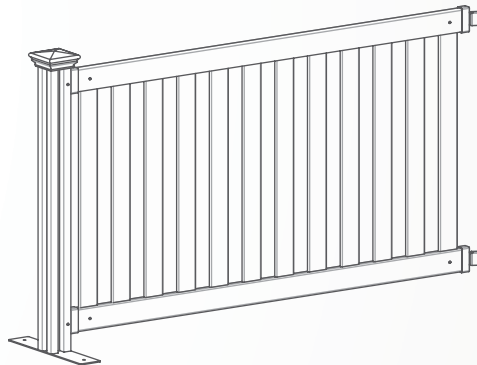

## GENERAL INFORMATION



### IMPORTANT

- + Check the inside of the larger pieces in your box for other materials packed inside.
- + When assembling components, place on a non-abrasive surface (i.e. shipping box) to avoid scratching.
- + We recommend an area approximately 5'x 8' for unobstructed assembling.
- + You should not need to use excessive force when assembling components.

## MISSING OR DAMAGED PARTS?

### VISIT OUR WEBSITE FIRST, SO WE CAN HELP YOU RIGHT AWAY!

Although great care has been taken to ensure proper packaging and handling of this product, occasionally problems occur. If you discover any missing, damaged, or defective parts, please visit our website to order replacement parts. If you experience any further trouble with your product, please contact our customer service department.

 [parts.nychbrands.com](https://parts.nychbrands.com)

 [support@zippity-outdoor.com](mailto:support@zippity-outdoor.com)

 **704-892-5222 / 877-234-6196**

*Customer service agents are available to take calls weekdays from 8am-5pm EST. If you call outside of business hours, please leave a voicemail.*

To help you quickly and accurately, please have reference item number **ZP19062** and the specific part name which can be found on page 4. It is helpful if you can provide the batch lot which is a stamped number on the end of the box.

## NEED ASSEMBLY HELP?

If you are having problems with the assembly or installation of this product, we are happy to assist you with the process, **so please give us a call at 704-892-5222 / 877-234-6196.**

## NEED TO RETURN?

If for some reason you need to return this product, please allow us to help resolve your issues first. If you still decide to return the product, **you will need to initiate the return from the company you originally purchased from.**



## Detailed Product Dimensions & Specifications

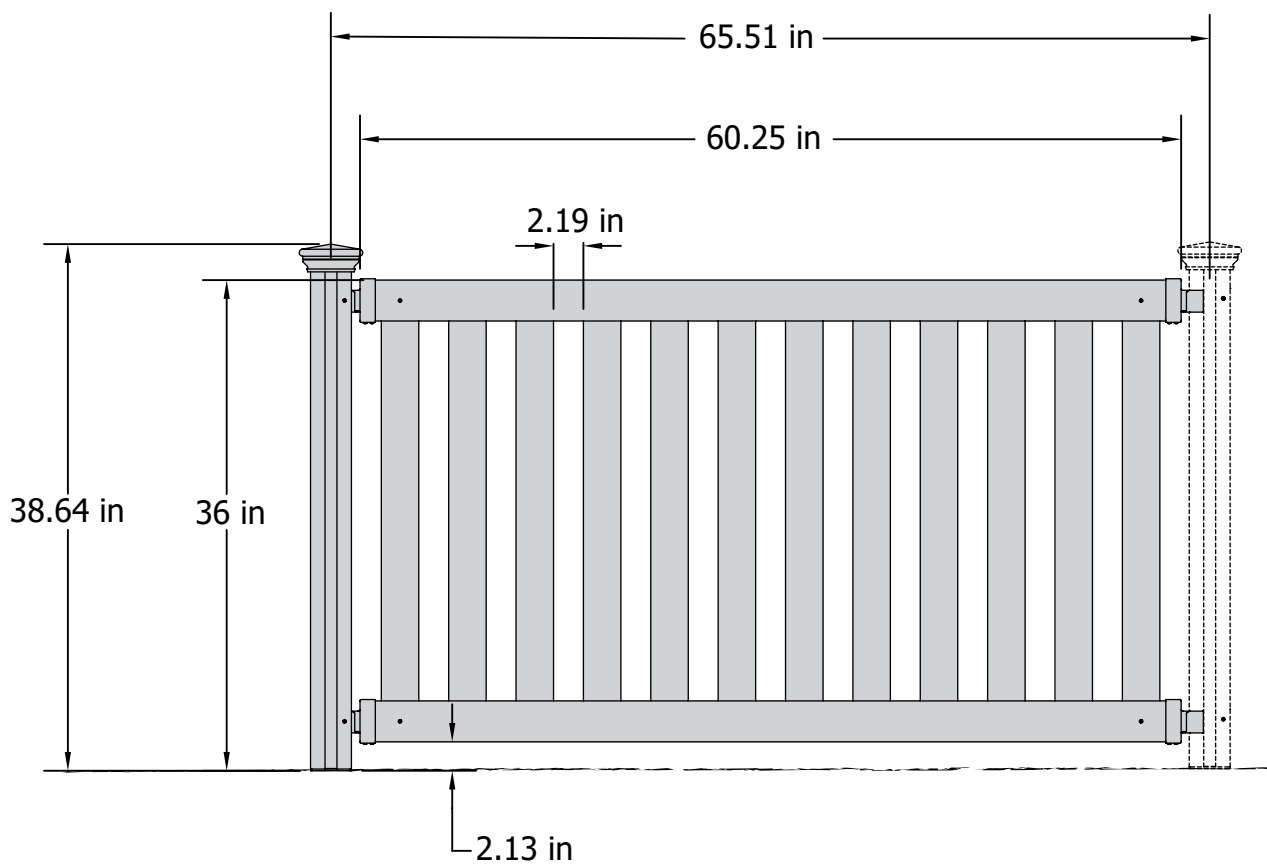

## STEP 1: LAY OUT MATERIALS

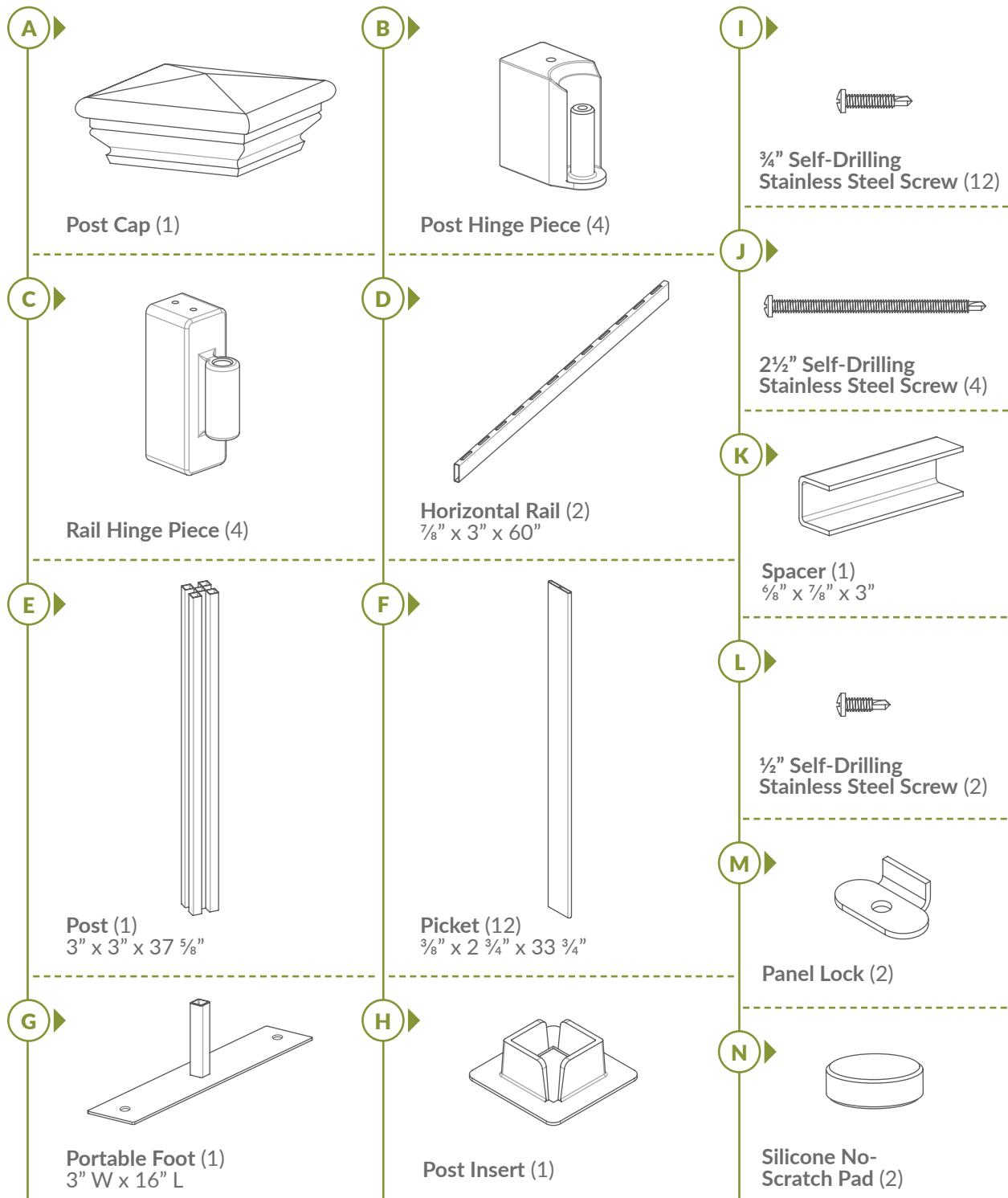

## STEP 2: ASSEMBLE FENCE PANEL

### STEP 2.1 ▶

1. Insert (12) Pickets (F) into a Horizontal Rail (D) until they bottom out inside the rail.
2. Insert the second horizontal rail over the pickets.
3. Drive (4) 3/4" Self-Drilling Stainless Steel Screws (I) through the pre-drilled holes in the rails.

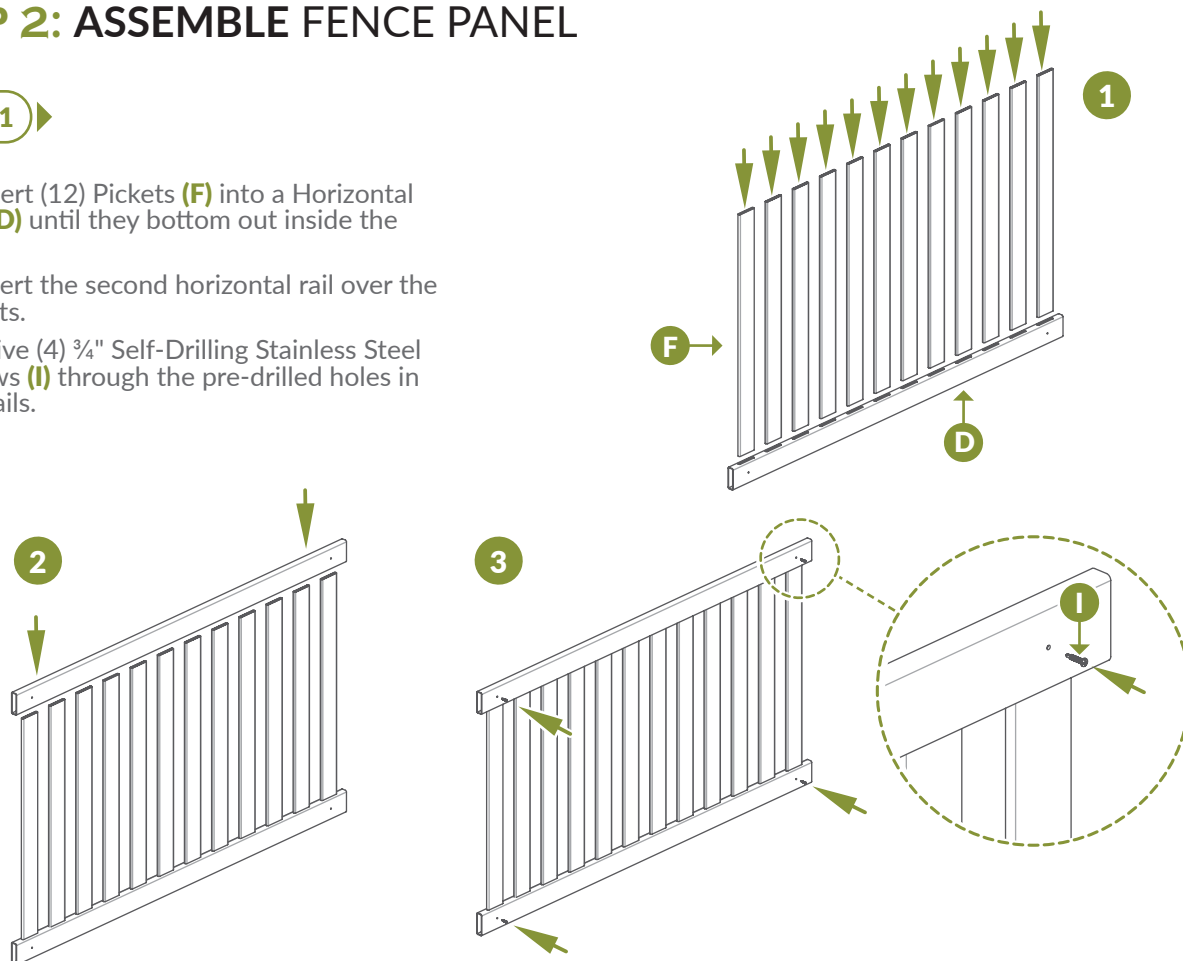

### STEP 2.2 ▶

1. Insert (4) total Rail Hinge Pieces (C) over the ends of the horizontal rails.
2. Drive (2) 3/4" self-drilling stainless steel screws into the pre-drilled holes in each rail piece.

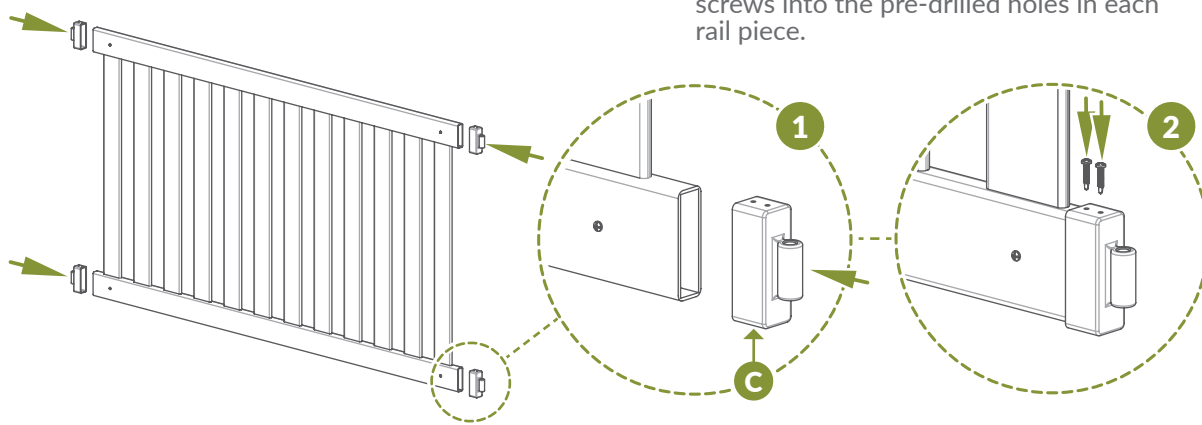

## STEP 3: INSTALL POST HINGE PIECES

### STEP 3.1 ▶

1. Insert (1) Post Hinge Piece **(B)** into the groove in Post **(E)**. Use Spacer **(K)** to set the height of the hinge piece from the bottom of the post.
2. Ensure that the hinge peg is facing upward, and drive (1) 2 ½" Self-Drilling Stainless Steel Screw **(J)** into the edge of the post to secure the post hinge.

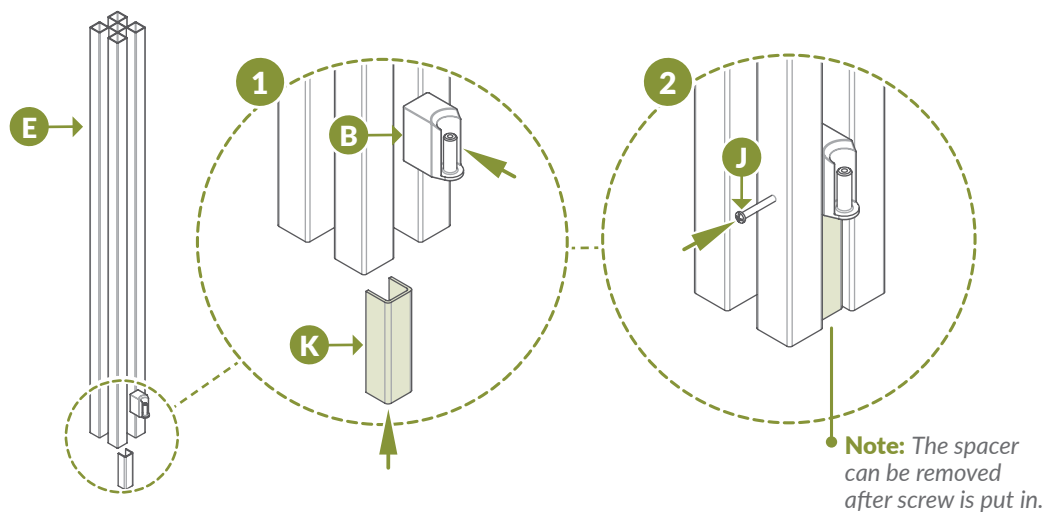

### STEP 3.2 ▶

- ▶ Insert the bottom rail hinge piece of the fence panel into the post hinge piece, and lay the joined post and fence panel on a flat surface.

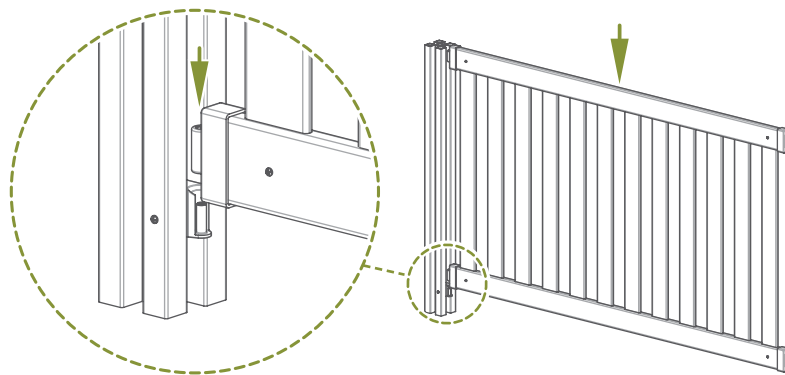

**STEP 3.3** ▶

1. Slide the remaining post hinge piece up the post channel to align with the top rail.
2. Drive (1) 2 ½" self-drilling stainless steel screw into the edge of the post to secure the post hinge.

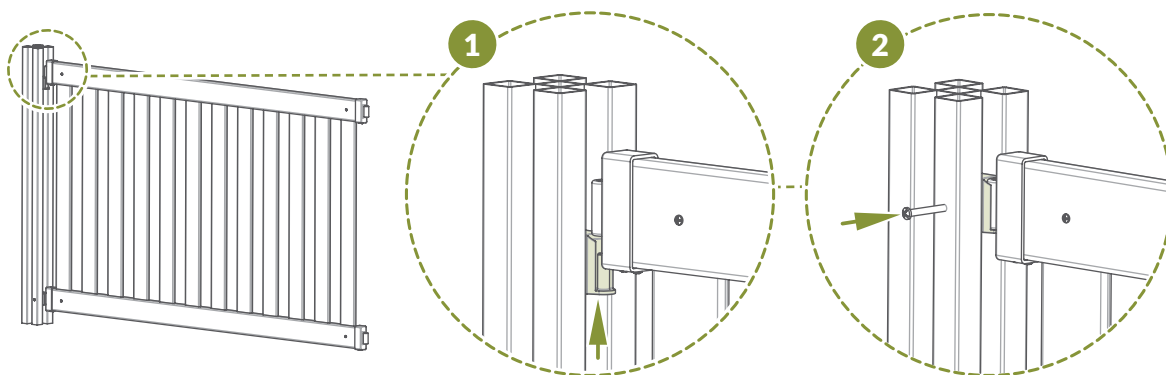
**STEP 3.4** ▶

▶ Repeat steps 3.1 through step 3.3 using the post from an additional panel, or the Davidson Hinged Portable Finishing Post (Item SKU: ZP19063) to end the run. Ensure that the spacer is used to achieve consistent hinge height.

**Note:** Please observe the best configuration for a 90° angle configuration below.

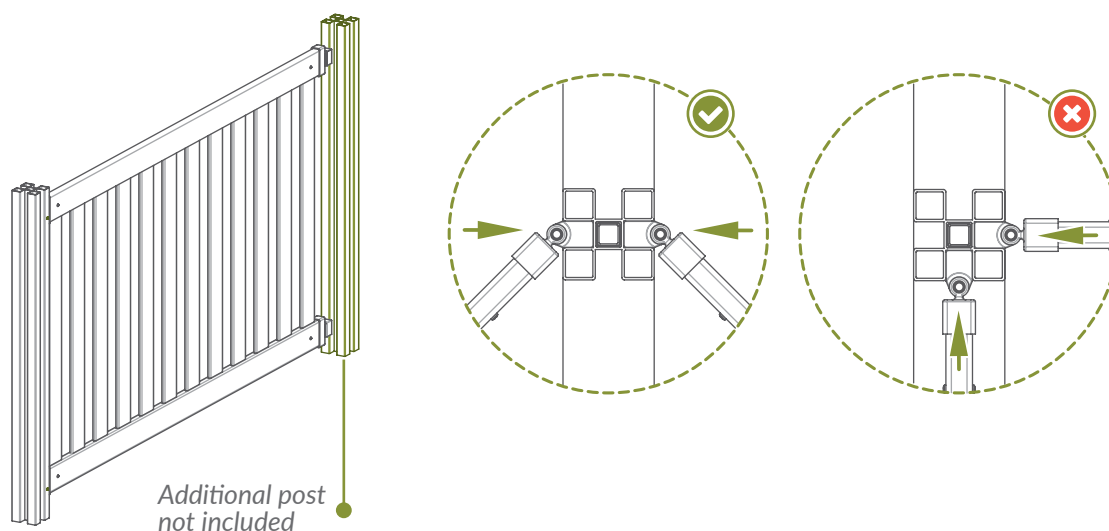

## STEP 4: INSTALL METAL FEET

### STEP 4.1 ▶

▶ Push Post Insert (**H**) into the center cavity at the bottom of the posts.

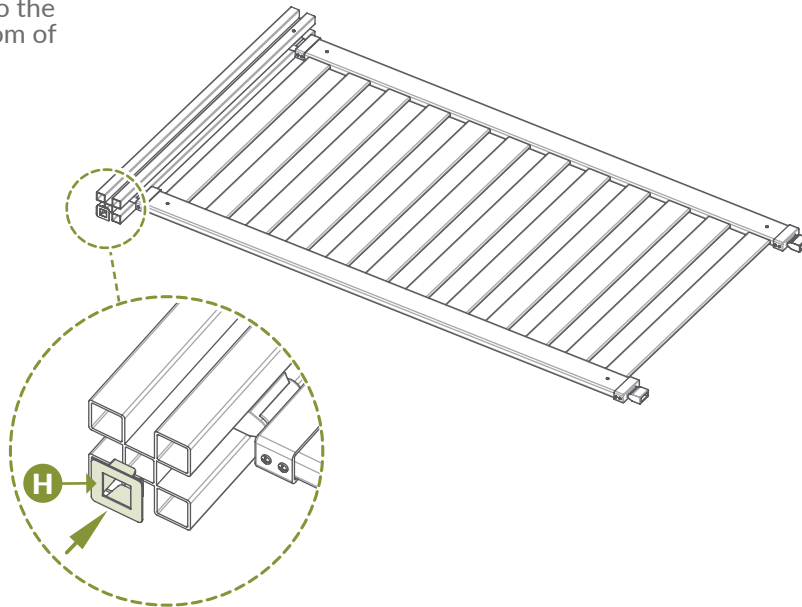

### STEP 4.2 ▶

1. Remove paper backing, and stick (2) Silicone No Scratch Pads (**N**) to the bottom of each foot.

2. Insert Portable Foot (**G**) into the center cavity at the bottom of the post.

**Note:** Inserting the portable feet may require some light force. Portable feet can be removed for storage.

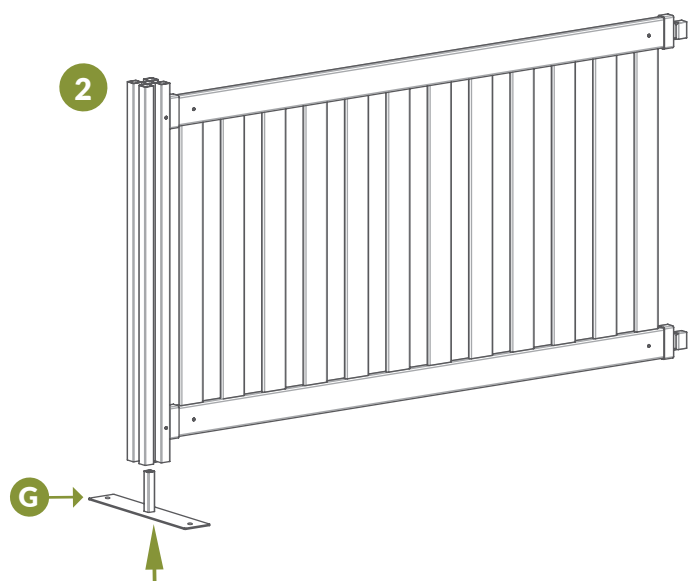
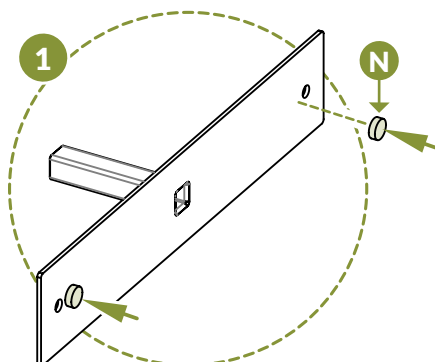

## STEP 5: INSTALL POST CAPS

### STEP 5.1 ▶

1. Install the Post Cap (A) over the top of the post to complete the fence assembly.
2. Continue the fence run with any additional purchased panels. One finishing post will be required for the very end of your fence run.

**Note:** Purchase the Zippity Hinged Portable Finishing Post (Item SKU: ZP19063) to complete the fence run.

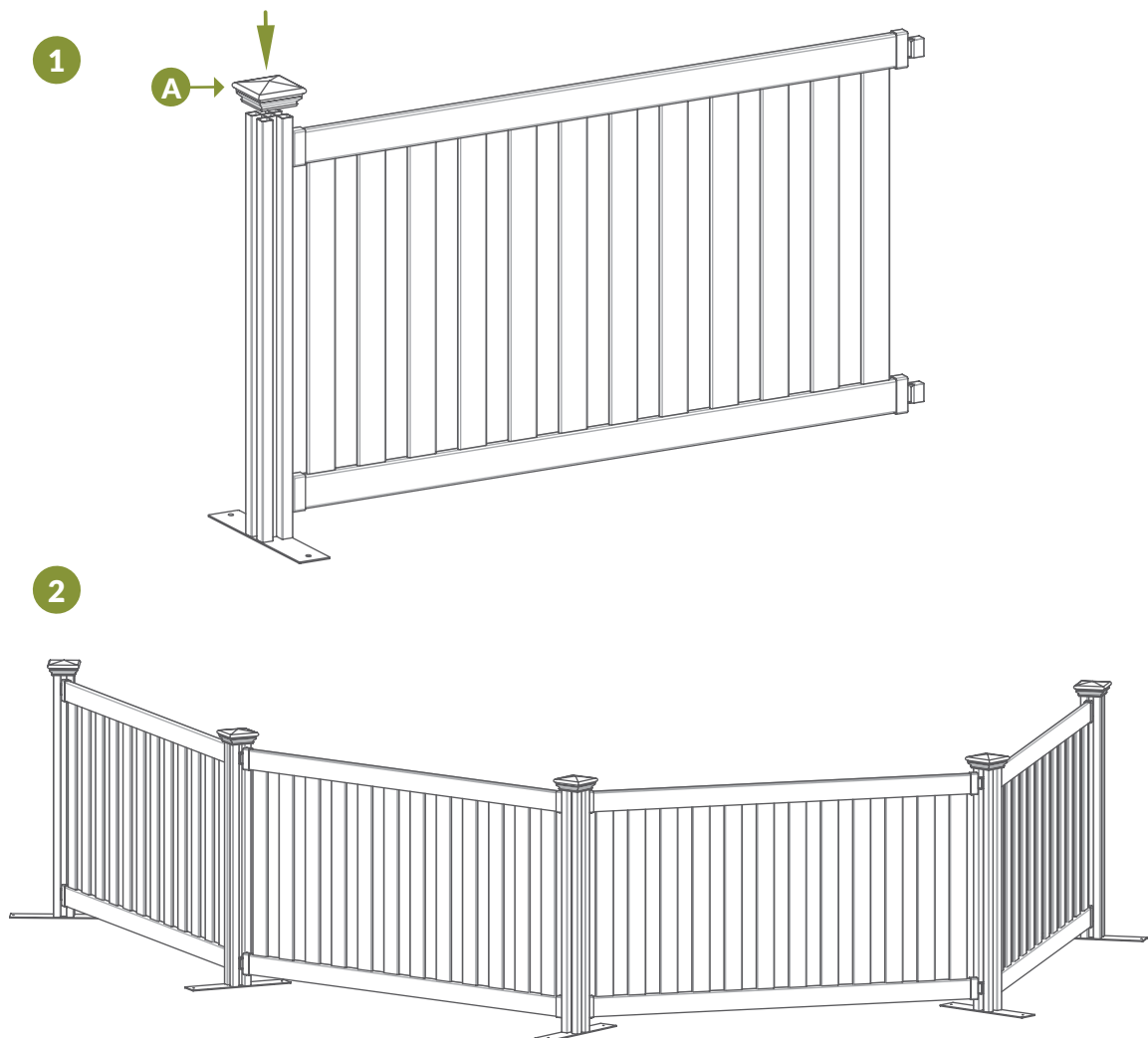

## STEP 6 (OPTIONAL): SECURE FENCE PANELS

### STEP 6.1 ▶

▶ Align the pre-drilled hole of the Panel Lock (**M**) with the pre-drilled hole in the top post hinge piece, and drive a 1/2" Self-Drilling Stainless Steel Screw (**L**) into the pre-drilled hole.

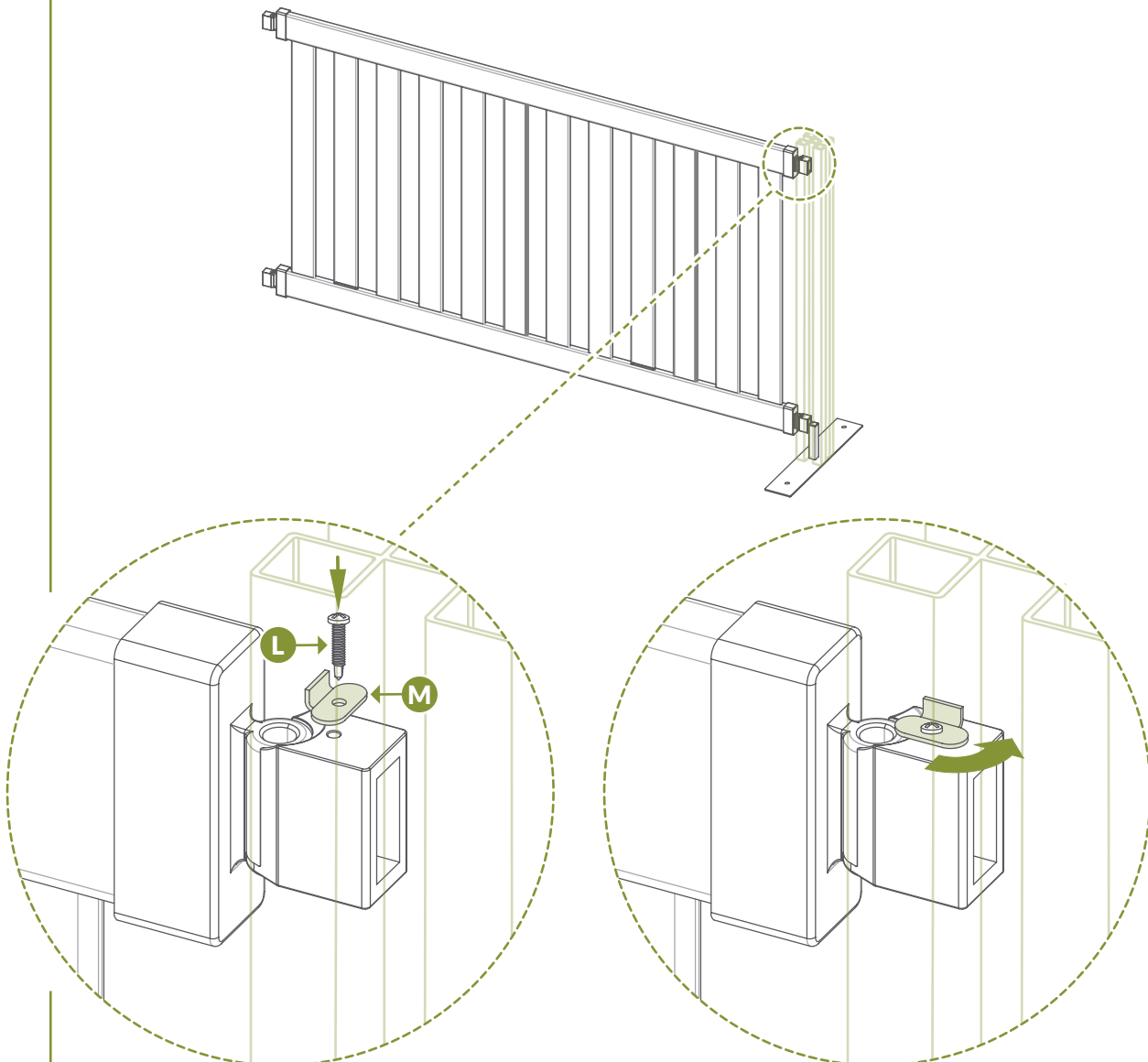

● **Note:**

Rotate the panel lock as shown to lock and unlock the vertical movement of the panel.



## STEP 7 (OPTIONAL): SECURE PORTABLE FEET

### STEP 7.1 ►

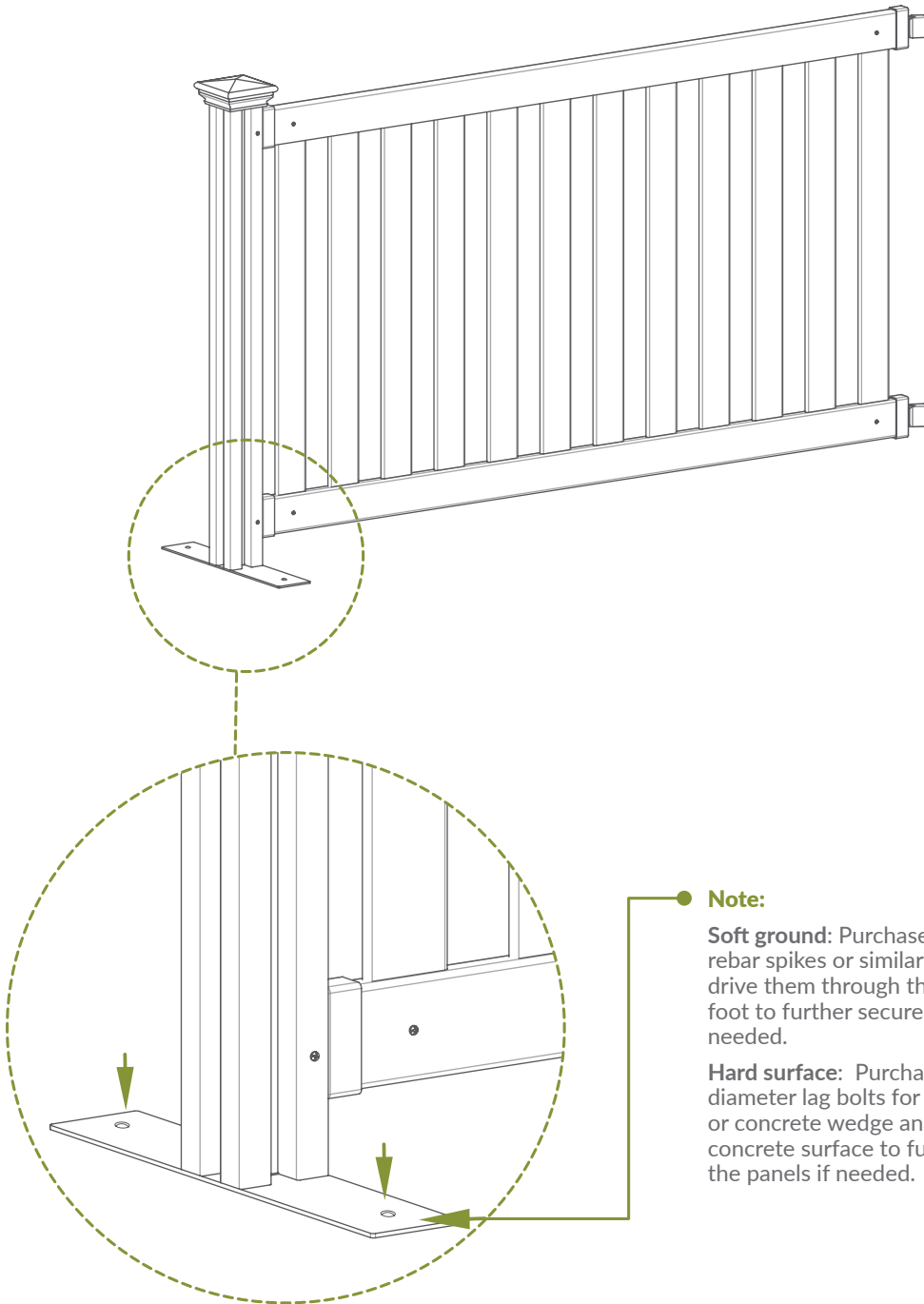
**Note:**

**Soft ground:** Purchase  $\frac{1}{2}$ " diameter rebar spikes or similar stake and drive them through the holes in the foot to further secure the panel if needed.

**Hard surface:** Purchase  $\frac{1}{2}$ " diameter lag bolts for wood surfaces or concrete wedge anchors for a concrete surface to further secure the panels if needed.

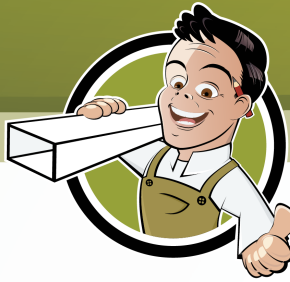

# ZIPPITY

*Easy Does It!*



6935 Reames Rd. Ste. K.  
Charlotte, NC 28216



[support@zippity-outdoor.com](mailto:support@zippity-outdoor.com)

704-892-5222  
877-234-6196



[WWW.ZIPPITY-OUTDOOR.COM](http://WWW.ZIPPITY-OUTDOOR.COM)